

#### ● 技术参数 SPECIFICATIONS

- 间距 (Pitch): 2.5
- 线数 (Poles): 2~20
- 适用线规 (Applicable wire): AWG#28~#22
- 额定电压 (Voltage rating): 250V DC/AC
- 额定电流 (Current rating): 3.0A
- 耐压值 (Withstand voltage): 1000V AC(有效值)
- 工作温度 (Working Temperature): -25°C ~ +85°C
- 绝缘电阻 (Insulation resistance):  $\geq 1000M\Omega$
- 接触电阻 (Contact resistance):  $\leq 0.02\Omega$
- 适用印制板厚度 (Applicable PC board thickness): 1.6mm

#### ● Terminal

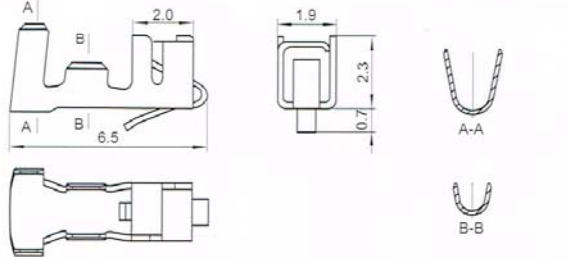

#### ● Mounting measurement 安装尺寸

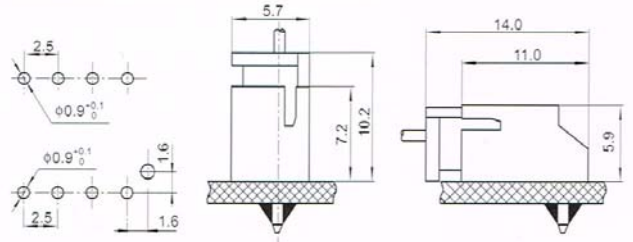

#### ● Housing

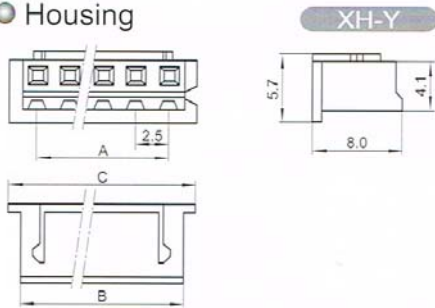

#### ● Wafer

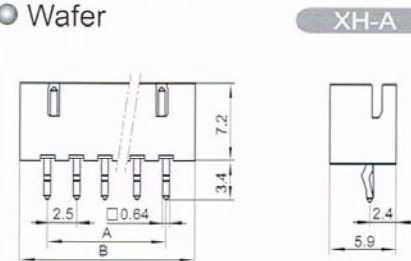

#### ● Wafer

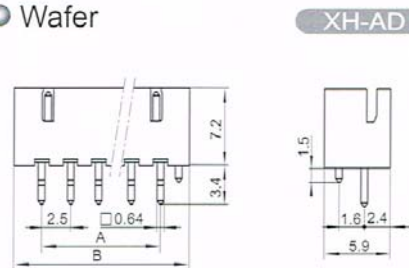

#### ● Wafer

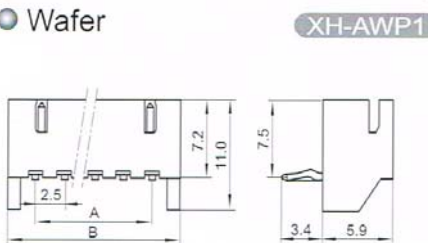

#### ● Wafer

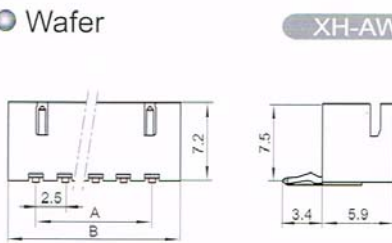

#### ● Wafer

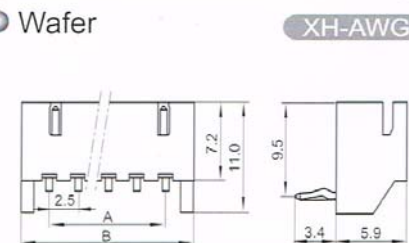

#### ● Housing

线数 Poles	型号 Type	尺寸 Dimensions(mm)		
		A	B	C
2	XH-2Y	2.5	5.7	7.3
3	XH-3Y	5.0	8.2	9.8
4	XH-4Y	7.5	10.7	12.3
5	XH-5Y	10.0	13.2	14.8
6	XH-6Y	12.5	15.7	17.3
7	XH-7Y	15.0	18.2	19.8
8	XH-8Y	17.5	20.7	22.3
9	XH-9Y	20.0	23.2	24.8
...	...	...	...	...
20	XH-20Y	47.5	50.7	52.3

#### ● Wafer

线数 Poles	型号 Type		尺寸 Dimensions(mm)	
	直式 (180°)	弯式 (90°)	A	B
2	XH-2A	XH-2AW	2.5	7.5
3	XH-3A	XH-3AW	5.0	10.0
4	XH-4A	XH-4AW	7.5	12.5
5	XH-5A	XH-5AW	10.0	15.0
6	XH-6A	XH-6AW	12.5	17.5
7	XH-7A	XH-7AW	15.0	20.0
8	XH-8A	XH-8AW	17.5	22.5
9	XH-9A	XH-9AW	20.0	25.0
...	...	...	...	...
20	XH-20A	XH-20AW	47.5	52.5