

NOTE:

- 1 MATERIAL:
HOUSING: 30% GLASS FILLED PBT, THERMOPLASTIC, BLACK.
CONTACT: PHOS BRONZE
- 2 FINISH: CONTACT PLATING: TIN-LEAD (60u INCHES MIN.)
SOLDERABILITY :95% COVERAGE MIN.;
TEST TEMPERATURE=230°C±5°C
TEST TIME = 5±5 SECONDS.
- 3. MECHANICAL SPECS:
DURABILITY: 50 CYCLES MIN.
INSERTION FORCE:300 GRAMS MAX.
WITHDRAWAL FORCE: 20 GRAMS MIN.
CONTACT RETENTION: 500 GRAMS MIN.
ACCEPTS: 0.20-0.30 [.008-.012] LEADS
- 4. ELECTRICAL SPECS:
VOLTAGE RATING: 250V AC,DC
CONTACT RESISTANCE: 20 MILLOHMS MAX.
CURRENT RATING: 1 AMPERE AC,DC
INSULATION RESISTANCE: 1000 MEGOHMS MIN.
DIELECTRIC WITHSTANDING VOLTAGE: AC 1000 V MIN.
- 5. OPERATING TEMPERATURE: -40°C TO +105°C

LADDER PRESENT FOR 24, 28 & 32 POSITION SOCKETS.

FINISH: CONTACT PLATING TIN (LEAD FREE); 60 UIN MIN. OVER 30 UIN Ni
SOLDERABILITY :95% COVERAGE MIN.;
TEST TEMPERATURE=260°±5°C;
TEST TIME = 5±5 SECONDS.

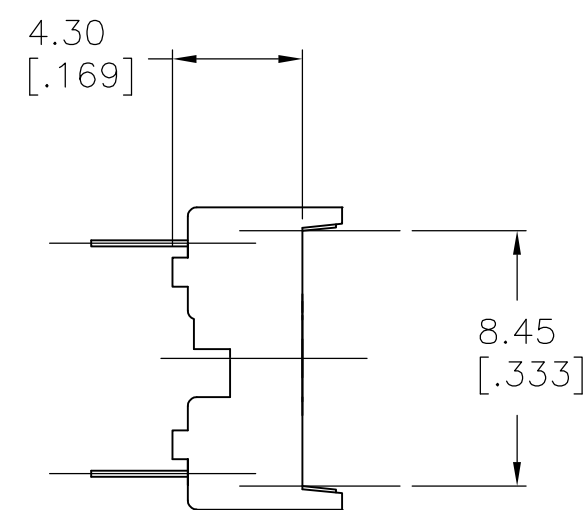
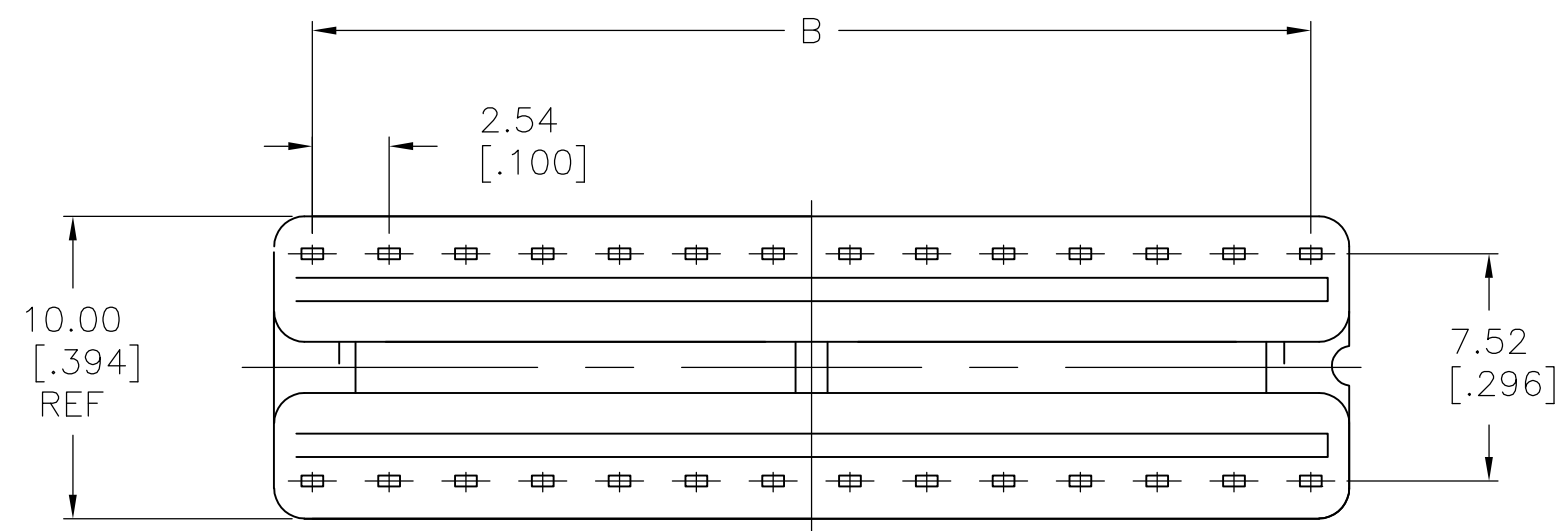
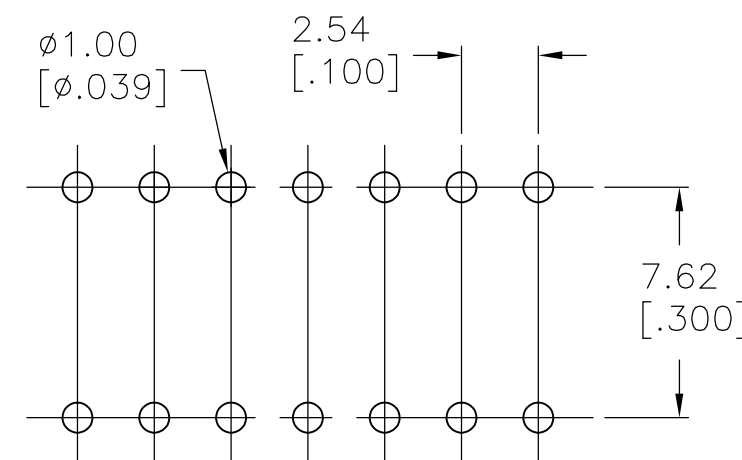
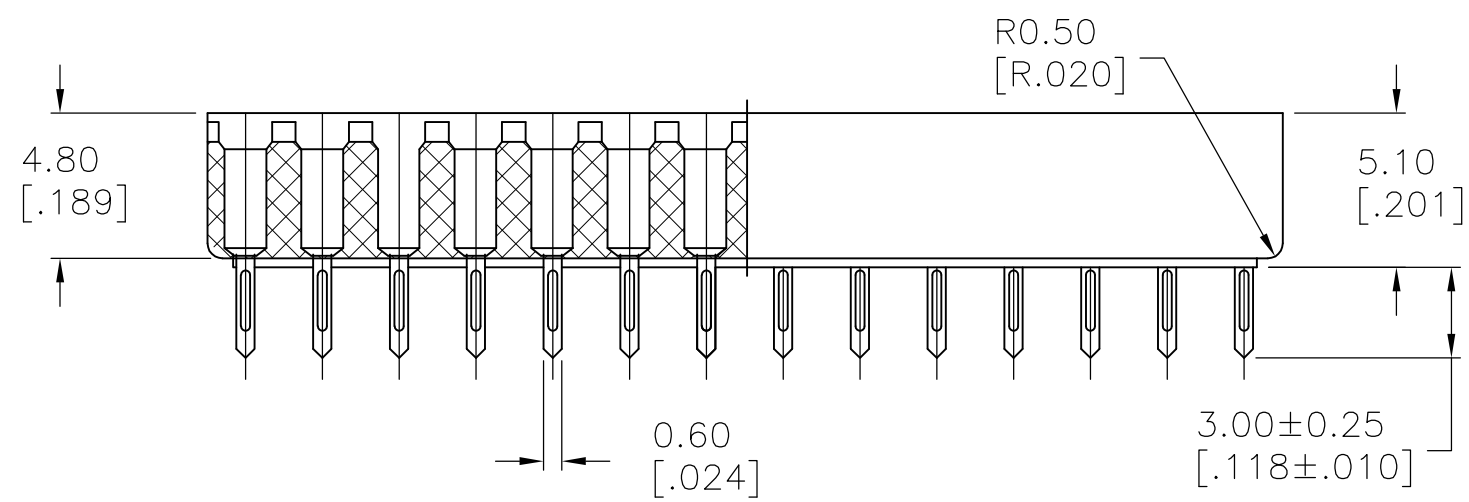

32	40.64 [1.600]	38.10 [1.500]	2-390261-0
28	35.56 [1.400]	33.02 [1.300]	1-390261-9
24	30.48 [1.200]	27.94 [1.100]	1-390261-8
22	27.94 [1.100]	25.40 [1.000]	1-390261-7
20	25.40 [1.000]	22.86 [.900]	1-390261-6
18	22.86 [.900]	20.32 [.800]	1-390261-5
16	20.32 [.800]	17.78 [.700]	1-390261-4
14	17.78 [.700]	15.24 [.600]	1-390261-3
8	10.16 [.400]	7.62 [.300]	1-390261-2
6	7.62 [.300]	5.08 [.200]	1-390261-1
FINISH	POS	A ±0.20 [.008]	B±0.15 [.006] PART NO.

THIS DRAWING IS A CONTROLLED DOCUMENT.		DWN		
DIMENSIONS: mm [INCHES]		CHK	NAME	
TOLERANCES UNLESS OTHERWISE SPECIFIED:		APVD	DIP SOCKET, .300 CENTER LINE LADDER STYLE	
0 PLC ± -	1 PLC ± -	PRODUCT SPEC	SIZE	CAGE CODE
2 PLC ± 0.2 [.008]	3 PLC ± -	APPLICATION SPEC	DRAWING NO	RESTRICTED TO
4 PLC ± -	ANGLES ± -	WEIGHT	-	
MATERIAL	FINISH	CUSTOMER DRAWING	SCALE 4:1	SHEET 1 OF 1
				REV M1