

剖面图 A-A

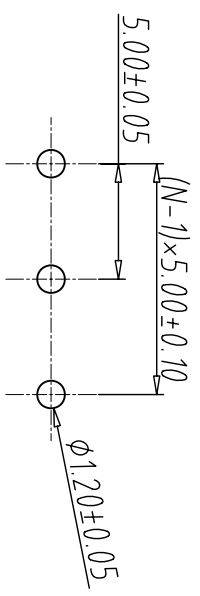

P.C.B. LAYOUT

**\*Material and plating**  
 Screw: M2.5, Steel, Zinc plating  
 Contact Material: Brass, Nickel plating  
 Plastic part: PA66, UL94V-0

**\*Mechanical property**  
 Operating Temperature: -40°C to +105°C  
 Maximum Temperature: +250°C per 5 seconds

**\*Electrical Properties**  
 Voltage rating: 300V  
 Current rating: 10A  
 Contact Resistance: 20mohm  
 Insulation Resistance: 5000Mohm\1000V  
 Voltage Resistance: AC2000V\1Min  
 Wire type: 24-12AWG 2.5mm<sup>2</sup>  
 Torsional Moment: 0.4Nm (3.6lbin)

**Coding:**

WJ128V, WJ128R

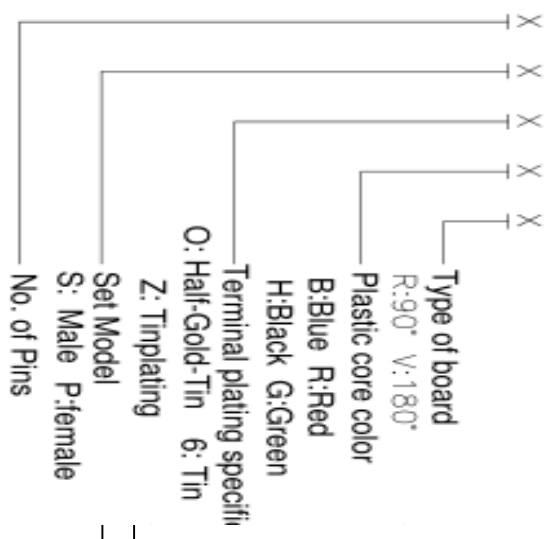

- X Type of board
- X R:90° V:180°
- X Plastic core color
- X B:Blue R:Red
- X H:Black G:Green
- X Terminal plating specification
- X O: Half-Gold-Tin 6: Tin
- X Z: Tinplating
- X Set Model
- X S: Male P:female
- X No. of Pins

02/03-24